



BB

BOTANICS

FAMILY GROWN

Virtual Web-Based Community Outreach Meeting

Town of Essex

May 21st, 2020

6PM EST

THE PROCESS

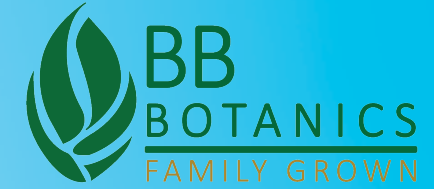

1. Effective April 28th, 2020 the Cannabis Control Commission approved Administrative Order #2: Administrative Order allowing virtual web based community outreach meeting M.G.L. c. 94G, M.G.L. c. 94I and 935 MCR 500.000 and 935 CMR 501.000
2. [LINK TO BB BOTANICALS LLC VIRTUAL WEB-BASED COMMUNITY OUTREACH MEETING](#) –
- THIS MEETING IS BEING RECORDED IN ACCORDANCE WITH ADMINISTRATIVE ORDER #2
1. Zoom Presentation from BB Botanicals LLC Covering Essential Information
 1. Presentation visualization will be broadcast through the Zoom portal shared screen feature
 2. Participants using audio only will hear a verbal presentation
2. Moderated Forum for Public Comment
 1. Questions/Comments can be submitted via email prior to and during the meeting [here](#)
 2. Questions/Comments can be submitted directly over Zoom via the Zoom Chat feature allowing a participant to submit text
 3. Questions/Comments will then be permitted over audio for the audio only attendees to be moderated by the Town Planner, Wesley Burnham.

ESSENTIAL INFORMATION

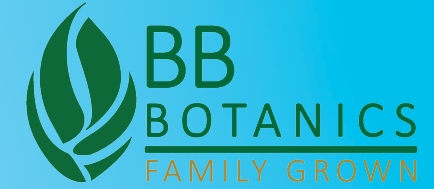

1. What is the proposed location of the proposed Marijuana Establishment (ME)?
2. What type(s) of Marijuana Establishments will be sited at the location?
3. Is the proposed ME allowed under current zoning bylaws/ordinances or is a zoning amendment required?
4. Is the proposed ME allowed by right or require local zoning permitting? What permits are required?
5. Is there a local licensing regulation pertaining to ME?
6. Is there a local Board of Health regulation pertaining to ME?
7. Does the proposed location comply with the 500-foot buffer zone from existing public or private school buildings (K-12)? Do local bylaws or ordinances create a smaller buffer zone?
8. If the applicant is moving into an existing building or building a new one, will its premises comply with the security requirements set forth in 935 CMR 500?
9. What steps will be taken by the Marijuana Establishment to prevent diversion to minors?
10. Information demonstrating how the applicant intends to ensure that the location will not constitute a nuisance to the community as defined by law.
11. A plan for how the Marijuana Establishment will positively impact the community. If the applicant is a marijuana retailer, be aware of whether the municipality has passed the local tax option and prepared to answer questions

THE TREMBLAY FAMILY

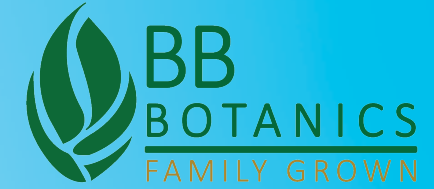

From Left: Nick Busa, Monique Tremblay, Jacquelyn Tremblay, Theresa (Terry) Tremblay, John Tremblay, Terese Tremblay, Brittany Ciccone, Kevin Ciccone

- The Tremblay Family - A Family Run Business for Over 30+ Years
- BB Botanics Will Be Family Owned And Operated

ITEMS 1 & 2

1. What is the proposed location of the proposed Marijuana Establishment (ME)?
2. What type(s) of Marijuana Establishments will be sited at the location?

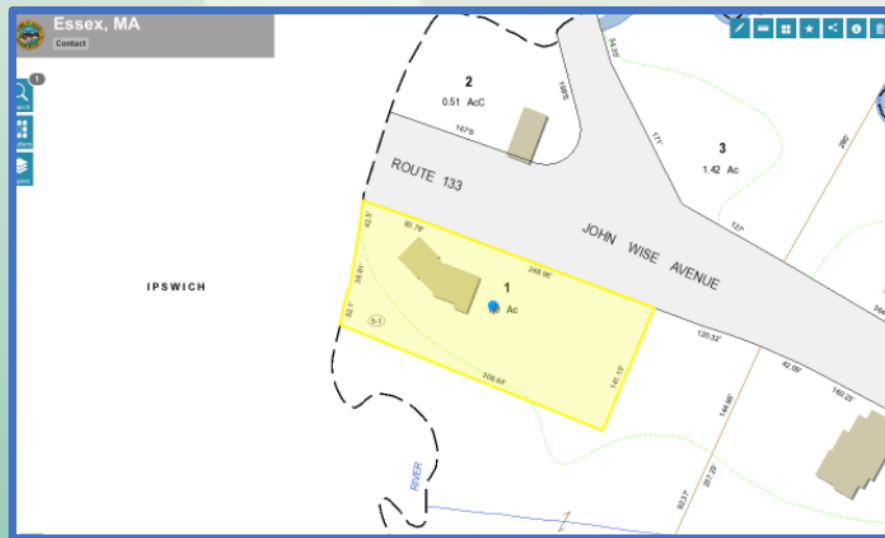

242 John Wise Ave Essex MA

Marijuana Retail

Marijuana Cultivator – Tier 1



ITEMS 3, 4, 5, 6, & 7

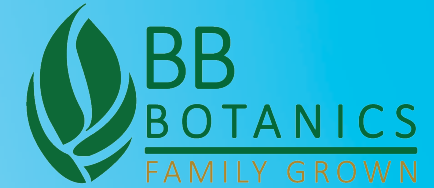

3. Is the proposed ME allowed under current zoning bylaws/ordinances or is a zoning amendment required? —————→ **YES**

4. Is the proposed ME allowed by right or require local zoning permitting? What permits are required? —————→ **YES**

5. Is there a local licensing regulation pertaining to ME? —————→ **NO**

6. Is there a local Board of Health regulation pertaining to ME? —————→ **NO**

7. Does the proposed location comply with the 500-foot buffer zone from existing public or private school buildings (K-12)? Do local bylaws or ordinances create a smaller buffer zone? —————→ **YES**

ITEMS 8, 9, & 10

8. If the applicant is moving into an existing building or building a new one, will its premises comply with the security requirements set forth in 935 CMR 500?

—————→ **YES**



10. Information demonstrating how the applicant intends to ensure that the location will not constitute a nuisance to the community as defined by law.

9. What steps will be taken by the Marijuana Establishment to prevent diversion to minors?

- Product Packaging Requirements
- Product Storage in Locked Vault
 - Inventory Tracking Software
- Monthly Physical Inventory Audits
 - Waste Disposal Logs
 - Restricted Access for Inventory Movements
 - No Loitering

ITEM 11

Positive Impact Plan

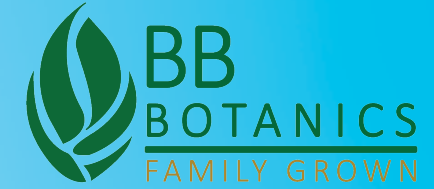

11. A plan for how the Marijuana Establishment will positively impact the community. If the applicant is a marijuana retailer, be aware of whether the municipality has passed the local tax option and prepared to answer questions



Support of Social Equity Program

A

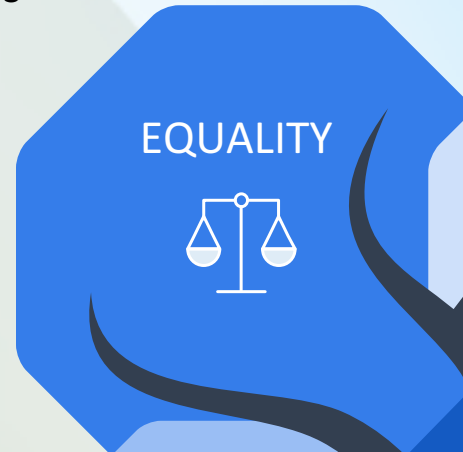

Hire from the CCC's
Social Equity Program.

Consumer Education
&
Awareness Initiatives

B



LOCAL
SUPPLIERS



C

Contract and hire MBE
and WBE suppliers.

LOCAL
HIRING



D

Hire Local Residents and residents
of disproportionately impacted
communities and veterans.

LOCAL SALES TAX REVENUE of 3%



Thank you!



BB
BOTANICS
FAMILY GROWN

Questions

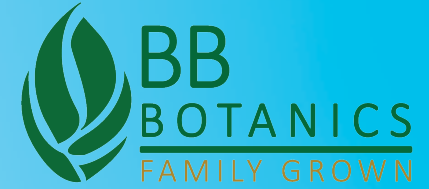

1. Questions submitted to the outreach email address posted on the public notice will first be addressed
2. Questions submitted and sent to the Hosts via the Zoom Chat feature will then be addressed
3. Questions over audio will then be fielded on an as-needed basis, with one participant speaking at a time
4. PLEASE BE KIND AND RESPECTFUL OF OTHERS